

SHARP®

DEHUMIDIFIER

OPERATION MANUAL

Model

DW-D20A

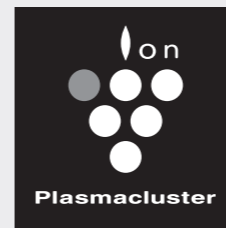

High - Density 7,000 *

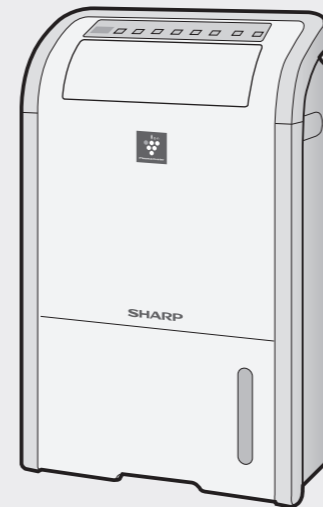

* The number in this technology mark refers to the approximate quantity of ions per cm³ of air released from the dehumidifier equipped with a high-concentration Plasmacluster ion generating unit which was measured at the center point (1.2 meter height above the floor) of high concentration Plasmacluster 7,000 applicable floor area room (temperature 20°C, humidity 50%) when the dehumidifier was placed against the wall and runs in laundry deodorizing mode with vertical swing "down" and horizontal swing "off".



Device of this mark is a trademark of Sharp Corporation.
Plasmacluster is a registered trademark or a trademark of Sharp Corporation.

SHARP®
SHARP CORPORATION

CONTENTS

PAGE

| | | |
|-----------------|--------------------|----|
| GETTING STARTED | FEATURES | 2 |
| | FAQS | 3 |
| | SAFETY PRECAUTIONS | 4 |
| | PARTS NAME | 8 |
| | BEFORE USE | 10 |

| | | |
|------------|--------------------------------|----|
| HOW TO USE | HOW TO OPERATE | 12 |
| | ● LAUNDRY DRYING / DEODORIZING | 12 |
| | ● DEHUMIDIFYING | 13 |
| | ● STOP | 13 |
| | EASY-TO-USE FUNCTIONS | 14 |
| | ● SWING LOUVER | 14 |
| | ● CHILD LOCK | 14 |
| | ● OFF TIMER | 15 |
| | ● PLASMACLUSTER ION ON/OFF | 15 |
| | ● NOTIFICATION SOUND OFF | 15 |
| | HOW TO DRAIN | 16 |
| | ● WATER TANK | 16 |
| | ● CONTINUOUS DRAINAGE | 17 |

| | | |
|----------------------|--|----|
| CARE AND MAINTENANCE | CARE AND MAINTENANCE | 18 |
| | ● FILTER/SENSOR | 18 |
| | ● WATER TANK | 19 |
| | ● MAIN UNIT | 20 |
| | ● WHEN NOT USING FOR A LONG PERIOD OF TIME | 20 |

| | | |
|----------------|-----------------|----|
| WHEN NECESSARY | SPECIFICATIONS | 21 |
| | TROUBLESHOOTING | 22 |

Thank you for purchasing this SHARP product.
Please read this Operation Manual carefully for proper usage.
Please be sure to read "SAFETY PRECAUTIONS" before use.
Keep this manual properly for future reference.

FEATURES



High-Density 7,000 *

A Powerful Dehumidifier with a High Concentration of Plasmacluster Ions for Cleaning, Quick Drying, and Deodorizing Room-dried Laundry

QUICK LAUNDRY DRYING

Quickly dry laundry with maximum air flow, and stop automatically.

LAUNDRY DRYING

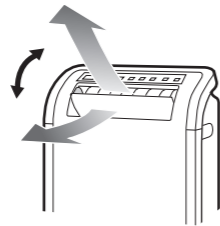

ECO LAUNDRY DRYING

Effectively dry laundry by combining dehumidity and ventilation, and stop automatically.

LAUNDRY DRYING

PLEASANT DEHUMIDIFYING

Maintain desired humidity for a pleasant room atmosphere.

AUTO DEHUMIDIFYING

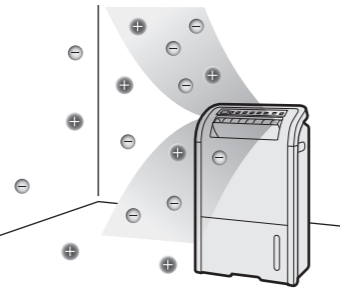

LARGE WATER TANK

Ensure plenty of dehumidification with a 4.2L tank. Also able to continuously drain.

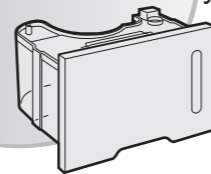

160° VERTICAL 90° HORIZONTAL * AUTO LOUVER

Widely dry and dehumidify laundry with wide louvers.

* This shows the air flow range when vertical swing is set to WIDE and horizontal swing is set to ON, which is different from the louver swing range.

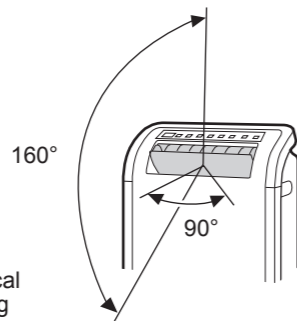

FAQs

Q Will the room get warm?

A Warm air will be coming out from the front air outlet, and when used in an enclosed room, the room temperature will go up.

Q I would like to continuously operate the unit in dehumidifying mode. Is continuous drainage possible?

A Continuous drainage is possible by using a commercially available hose (inner diameter 15mm). [Pages 11,17](#)

Q The water does not accumulate in the tank. Is the unit dehumidifying?

A When the temperature is high, or when the temperature or humidity is low, air flow mode will operate, and the unit will not dehumidify. The water will not be collected in the tank during this time. [Page 22](#)

Q The sound seems too loud?

A There is a sound at the start of operation/during operation/when the unit stops. It is the sound of compressor operation or refrigerant (coolant) circulation. [Page 23](#)

Q The CURRENT HUMIDITY display seems wrong?

A The CURRENT HUMIDITY display is only for reference. (The value will not necessarily be the same with other devices.)
When the humidity suddenly changes immediately after the laundry dry mode starts, the display might be different from the actual humidity.
When the humidity is 31% or lower, the display will show [Lo]; and 91% or above will show [Hi].

Q The air flow seems to get stronger on its own?

A Even if the dehumidifying (Auto/Lo) operation is set, the air flow will increase automatically during the following situations:

- When the room temperature is 38°C or above (Air flow only) in order to lower the internal temperature.
- When the room temperature is 15°C or lower (Air flow only) in order to prevent frost forming inside.

■ Please read "TROUBLESHOOTING" for further details. [Pages 22, 23](#)

* The number in this technology mark refers to the approximate quantity of ions per cm³ of air released from this product which was measured at the center point (1.2 meter height above the floor) of high concentration Plasmacluster 7,000 applicable floor area room (temperature 20°C, humidity 50%) when the dehumidifier was placed against the wall and runs in laundry deodorizing mode with vertical swing "down" and horizontal swing "off".

SAFETY PRECAUTIONS

To prevent any possible injury to persons or damage to property, be sure to follow the basic safety precautions, including the following:

■ The degree of injury or damage resulting from incorrect use or operation while ignoring the indicated matters is classified and explained with the following symbols.

WARNING

Indicates a potentially hazardous situation which, if not avoided, could result in serious injuries or even death.

CAUTION

Indicates a potentially hazardous situation which, if not avoided, could result in injury to persons or damage to property.

■ The precautions to be observed are indicated with the following symbols and signs.



 This symbol indicates a prohibited action.

 This symbol indicates a mandatory action.



WARNING To prevent fire, electric shock or injury

Power Plug, Power Cord

-  ● Do not damage the power cord.
 - Do not process, forcibly bend, pull by force, twist or bind the power cord.
 - Do not place heavy objects on the power cord, or apply too much force to it.
 - Do not damage the power cord while moving the unit on its casters.
(Otherwise, fire or electric shock may be caused.)
 - Do not plug/unplug the power cord with wet hands.
(Otherwise, electric shock may be caused.)
 - Do not connect the unit from extension cord or multiple wiring with other electronic appliances.
(Otherwise, electric shock, fire or heat may be caused.)
 - Do not use other than the rated voltage (220-240V).
 - Do not operate or stop the unit by using the power plug.
(Otherwise, electric shock or fire may be caused.)
-
-  ● Make sure there is no dust on the power plug and insert it into the outlet completely. Any dust around the power plug should be wiped off with a dry cloth periodically.
(Accumulated dust may result in poor insulation from humidity, etc., thereby causing fire or electric shock.)

During Usage

-  ● Do not put fingers or foreign objects (pin, needle, stick, etc.) into the air outlet or air intake.
(The fan is rotating at high speed inside. Injury, electric shock and malfunction may occur.)
- Do not make modifications. Disassembly, repairing, modifications shall not be made by a person other than the service engineer.
(Otherwise, fire, electric shock or injury may be caused.)
- Do not place spray cans close to the main unit. Do not use flammable hazardous materials (gasoline, thinner, etc.) near the main unit.
(Otherwise, ignition of fire, explosion may occur.)
- Do not directly apply air to human bodies for a long period of time.
(Otherwise, sickness or health problem may occur.)
- Do not place the unit near heating appliances.
(Otherwise, plastic parts will melt and fire ignition may occur.)

In Case Of An Exception (e.g., burnt smell)

-  ● Be sure to immediately shut down the product, remove its power plug and contact customer service center for repair.
(Otherwise, electric shock or fire may be caused.)
- For repairs, please consult the store where you purchased the product or the nearest customer service center.
(An incomplete repair may cause electric shock, fire or injury.)

Before Maintenance

- Be sure to shut the unit down and remove its power plug.
(The inner fan is rotating at high speed and may cause injury.)

Be sure to follow...



CAUTION In order to prevent electric leakage and injury, and protect your household goods

Power Plug, Power Cord

- **Always hold the power plug, when unplugging the unit.**
(Otherwise, fire, electric shock, short circuit may be caused.)
- **If you are planning not to use the unit for a long time, unplug the power plug from outlet for safety.**
(Otherwise, electric shock, electric leakage or fire may be caused.)

During Usage

- **Do not knock down or drop the main unit.**
Do not store or move with the main unit down on its side
(Otherwise, equipment damage or malfunction such as water/electric leakage may be caused.)
- **Do not use the unit in a tight enclosed space such as closet or in between furniture.**
- **Do not block the air outlet or air intake.**
(otherwise, air flow will be obstructed, resulting in overheating or ignition.)
- **Do not use the product in a place where it can easily get wet or in the bathroom.**
- **Do not wash the product directly with water.**
- **Do not place an object with water such as a vase on top of the main unit.**
- **For indoor use only. Do not use the unit under direct sunlight or in any location exposed to rain and wind.**
- **Do not leave the unit where oil or flammable gas may leak.**
(Otherwise, electric shock, over-heating, electric leakage or fire may be caused.)
- **Do not use on a high place such as on the table.**
(When the main unit falls, injury may be caused.)
- **Do not sit on or lean on to the product.**
(Otherwise, injury may be caused from moving or falling.)
- **Do not use the drained water for drinking or feeding.**
(Otherwise, health problems may be caused.)
- **Do not expose the air from this product directly to heating appliances.**
(Otherwise, incomplete combustion of heating may be caused.)
- **Do not use for storage/special purpose for artworks or academic materials.**
(Otherwise, quality degradation of stored materials may be caused.)
- **Do not use for long hours in a room with people.**
Heat will generate during "(QUICK AUTO/ECO AUTO/CONTINUOUS) laundry drying"/ "dehumidifying". Increased room temperature and dryness may cause health problems.
Look out when the following type of people is in the room.
(Baby, children, elderly, person who cannot operate this product.)



- **Always have plenty of room around the main unit.**
(Poor ventilation may cause over-heating, fire, malfunction.)

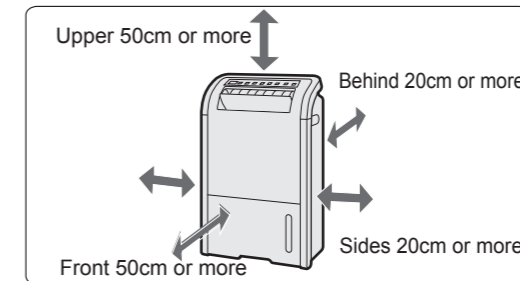

- **This appliance is not intended for use by persons (include children) with reduced physical, sensory or mental capabilities or lack of experience and knowledge, unless they have been given supervision or instruction concerning use of the appliance by a person responsible for their safety.**
- **Children should be supervised to ensure that they do not play with the appliance.**
- **Lift up the main unit and move on easily scratched floors like tatami, rough places and thick carpets.**
Do not drag the casters to change the direction of the main unit.
(Otherwise, floor surface or carpet may be damaged.)
- **Before moving the main unit, always stop the operation and dispose the water in the water tank.**
- **Operate the unit only on level, stable surfaces.**
- **Check for bent hose/falling height when conducting continuous drainage and place the hose where it will securely drain.**
(Inner water may leak in the room and dampen the furniture or may cause electric shock/leakage, fire.)
- **When using drain hose, make sure the surrounding environment will not fall below freezing point.**
- **Be sure to clean the product, floor and surroundings when using the product in a same place for a long period of time.**

NOTE

- **If there is a noise in TV/radio or radio clock does not display the correct time, move the product away as far as possible.**
(Otherwise, radio disturbance may be caused.)

PARTS NAME

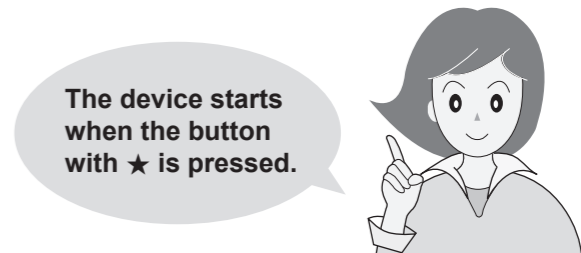

MAIN UNIT AND CONTROL PANEL

Control Panel

Plasmacluster Ion ON/OFF button
Turn Plasmacluster Ion operation on/off. (Page 15)

Plasmacluster Ion indicator light (blue)
Lighting ... Plasmacluster Ion is running.

CURRENT HUMIDITY display (green)
Displays the current humidity (estimate).
Lo 31% or below
32 - 90 ... Current humidity (est.) is displayed in the unit of 1%.
Hi 91% or above

CHILD LOCK button (Page 14)
Enable/Disable Child Lock.

CHILD LOCK indicator light (green)
Lighting... Child Lock is enabled

OFF TIMER button (Page 15)
Sets the time for OFF TIMER

OFF TIMER indicator light (green)
"2h" lighting ... 2 hours is set for OFF TIMER.
"4h" lighting ... 4 hours is set for OFF TIMER.
"6h" lighting ... 6 hours is set for OFF TIMER.
"6h" blinking ... Auto off function operate (Page 11)

DEHUMIDIFY button ★ (Page 13)
Change the mode of dehumidifying operation.
Dehumidifying mode indicator light (green)
Display the operation state.

Tank FULL indicator light (red) (Page 16)
Blinking The water drainage tank is full.

STOP button (Page 13)
Stop the operation.

LAUNDRY button ★ (Page 12)
Change to laundry operation mode.
Laundry mode indicator light (green)
Display the operation status.

VERTICAL SWING button (Page 14)
Switch the vertical swing mode of the louver.

VERTICAL SWING indicator light (green)
Show the swing status.

HORIZONTAL SWING button (Page 14)
Turn horizontal swing of the louver on/off.

HORIZONTAL SWING indicator light (green)
Lighting Louver automatically swings right and left.

Front View

Louver (Air Outlet) (Page 14)

Water tank (Pages 16, 19)

- Tank lid
- Tank handle
- Float
Do not take off the expanded polystyrene. (Otherwise, the sensor does not detect filling of the tank.)
- Water level window
- Tank knob

Sensor (temperature and humidity sensor)
Located at the inside of the knob.

Casters (four)

Back View

Filter (Air Inlet)

- Filter
- Filter cover

Knob (Both Sides) (Page 11)

Continuous drainage hole (Rubber Cap)

Power cord

Power plug

PARTS NAME

BEFORE USE

CAUTION

Lift up the main unit and move on easily scratched floors like tatami, rough places and thick carpets.
[Otherwise, the surface of floor or carpet may be damaged.]

WHEN USING FOR THE FIRST TIME

There might be some water left in the water tank from the factory product inspection. This is not a malfunction.

1

Packaging material

Take out the product from the box

- Always hold the knob and take out from the box.
- Keep the box and packaging materials for future product storage.

- The louver will automatically move and close.

2

220V power supply

Place it on a level, stable place and insert the power plug into outlet

INSTALLATION LOCATION

Avoid places with direct sunlight.

- May cause deformation or safety device activation.

If there is a noise in TV/radio or radio clock does not display the correct time, move the product away as far as possible.

Level, stable place

- Thick carpet or futon is a very unstable place.

Operate it in a room with temperature from 3°C to 38°C.

- The compressor will stop and will not dehumidify when the room temperature is lower than 3°C or higher than 38°C. (Switch to air flow mode)

- Do not use in the following places**
- With a lot of salt such as seaside area.
 - With a lot of machine oil.
 - With a lot of sulfide gas such as hot-spring area.
 - With a lot of steam or oily smokes.
- Do not use any cosmetic products * formulated with fluoro-resin or silicone near the dehumidifier.**
- Plasmacluster ion may not generate if fluoro-resin or silicone gets into the main unit.
 - * Hair care products (hair coating solution, hair mousse, hair treatment), cosmetic products, antiperspirant, antistatic products, waterproof spray, waxing products, glass cleaner, chemical cloth, wax, etc.

WHAT YOU NEED TO KNOW

When moving

1

Stop the operation and dispose water in the tank

- Bundle the power cord and hold along with the knob to move. Pulling on the power cord will damage the cord.

2

Knob (both sides)

Hold the knob to move

Caster

Defrosting

When the room temperature falls below 15°C, the unit will automatically start defrosting in order to prevent frost from forming inside the main unit.

- Once every 45 minutes, the compressor will stop and "HIGH" air flow mode will operate (for about 12 minutes). The lower the room temperature, the longer the compressor stop time.
- The compressor will stop and will not dehumidify during defrost, and water will not be collected in the tank.

Auto Off function

The operation will stop automatically after 12 hours in case the unit has been forgotten to be turned off. (The OFF TIMER "6h" indicator light blinks)

Start operating

Stop operating

To cancel the Auto Off function (For continuous drainage)

The Auto Off function is set when the power plug is plugged in.

Operation stopped

Beep

Press both for 3 seconds

Press both for 3 seconds

- The Auto Off timer will turn off when you press and hold both the OFF TIMER button and STOP button for 3 seconds.
- Once the power plug is pulled, the Auto Off function will be set again.
- Press and hold both OFF TIMER button and STOP button for 3 seconds to restart the Auto off function.

It will take about 3 minutes to start dehumidifying again for re-operation.

- In order to protect the unit, the compressor will not operate for 3 minutes immediately after plugging in the power plug or stopping (QUICK/ECO/CONTINUOUS) laundry drying/dehumidifying operation. Air flow mode will operate and the unit will not dehumidify.

HOW TO OPERATE

CAUTION

Do not block the air outlet with clothes

[Otherwise, over-heating, fire or malfunction may be caused]

LAUNDRY DRYING / LAUNDRY DEODORIZING



Select your desired operation

- "QUICK AUTO" will operate immediately after the power plug is plugged in.
- Unless the power plug is unplugged, the unit will operate in the last mode that was selected.

Auto Operation

QUICK

QUICK AUTO (Auto Stop)

Dry your laundry with "Full Power" air flow. (Dry and dehumidify)

- The operation will automatically stop when the humidity level falls below 55% after about 30 minutes of operation or when the unit has operated for about 3 hours. (A beep will sound when the operation stops and the QUICK indicator light will blink)

When you want to dry your laundry quickly

Dehumidifying operation (compressor operation) and Air Flow operation (compressor stopped) will alternately repeat with "HIGH" air flow and dry the laundry.

- The operation will automatically stop when the humidity level falls below 60% after about 30 minutes of operation or when the unit has operated for about 3 hours. (A beep will sound when the operation stops and ECO indicator light will blink)

CONTINUOUS

Continuous

Dry your laundry continuously with "Full Power" air flow. (Dry and dehumidify)

When you want to dry your laundry with continuous operation

Deodorize your laundry with "Full Power" air flow. (Air Flow Operation)

- Plasmacluster ion will be "ON" even if it is set to be "OFF". (Plasmacluster "OFF" is not available.)



Select a louver swing mode
(Page 14)

- Make sure the air blowing out from air outlet is directly pointing to your laundry.

The distance between air outlet and laundry should be 10cm or more.

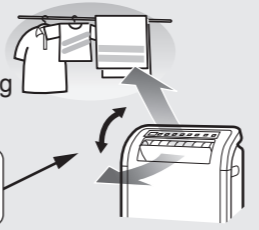

NOTE

- Stretch the wrinkles of wet laundry and dry in an airy place.
- Dry thick laundry in a well ventilated place.
- The drying time will be longer for low temperature room, large room, and when the quantity of laundry is large. Auto operation (QUICK AUTO/ECO AUTO) may stop even the laundry has not been dried. Conduct Auto operation again for more drying time.

DEHUMIDIFYING



Select your desired operation

- The unit will operate in AUTO immediately after the power plug is inserted.
- Unless the power plug is unplugged; the unit will operate in the last mode that was selected.

1

AUTO

LOW

HIGH

When you want to automatically dehumidify

The temperature and humidity sensor will adjust the dehumidification amount for proper humidity level according to room temperature. When the room temperature is too low or too high, it might not reach the appropriate humidity level. (Page 22)

| Room temperature | Appropriate humidity |
|------------------|----------------------|
| 3°C~26°C | 60% |
| 26°C~38°C | 55% |

Quietly dehumidify with "LOW" air flow.

* The air flow might increase depending on the room temperature. (Page 3)

Dehumidify with continuous operation of "HIGH" air flow.



Select a louver swing mode (Page 14)

STOP



- The indicator light will go off and louver will shut automatically.
- Run the internal drying operation (laundry deodorizing operation) when planning not to use for a long time. (Page 20)

EASY-TO-USE FUNCTIONS

SWING LOUVER

Do not forcibly move the louver with hands. Otherwise, malfunction may be caused.

RIGHT/LEFT

During operation

Swing "ON"

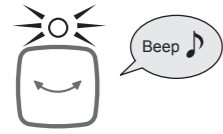

H. SWING

Swing "STOP"

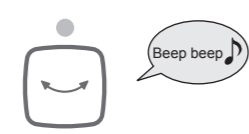

H. SWING

- Press the button and set the louver at the desired position. Then the indicator light turns off.

During operation



V. SWING

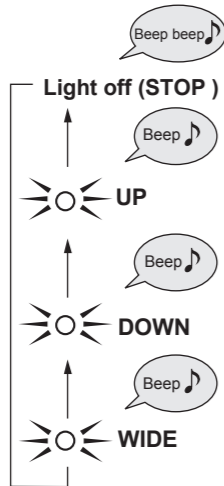

Louver movement angle: Approx. 160°
(Reach of wind: Approx. 180°)

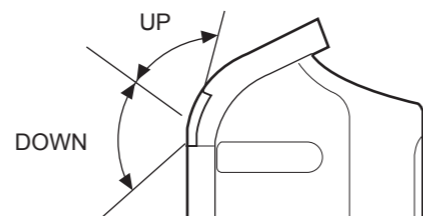

"WIDE" repeats "UP" and "DOWN" movements.

CHILD LOCK

To prevent incorrect operation by children.

ENABLE/DISABLE

"Enable"



CHILD LOCK
(PRESS 3 SEC.)

"Disable"



CHILD LOCK
(PRESS 3 SEC.)

- Only the following operations can be performed when the child lock is enabled:
During operation ... Stop operation, disabling the child lock.
- Stopped ... Disabling the child lock.
The child lock will be disabled when the power plug is unplugged.

OFF TIMER

During operation



OFF TIMER

Select the desired time

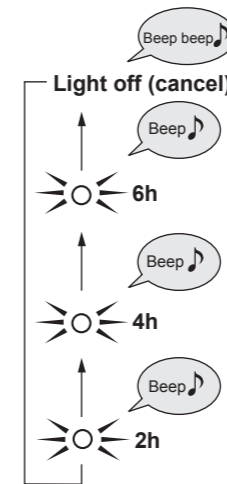

- You will hear a notification sound (Long beep) once the preset time is reached and the operation will stop.

- The OFF TIMER indicator light will change as the operation time progresses.
- When the water tank becomes full during off timer operation, the operation will stop but the off timer counting will continue. (You may continue the timer operation after draining.)
- To disable the off timer, press the off timer button and turn the indicator light off (i.e. cancel it).

PLASMACLUSTER ION ON/OFF

Turn the Plasmacluster ion on/off.

1

During operation

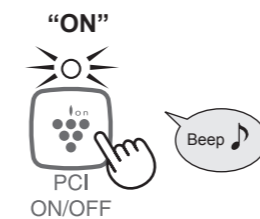

PCI
ON/OFF

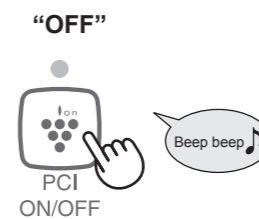

PCI
ON/OFF

- Even if the Plasmacluster ion is "OFF", if laundry deodorizing operation is selected, the Plasmacluster ion will automatically turn "ON".

NOTIFICATION SOUND OFF (Tank full/End of Off Timer/End of Auto Off function)

Use this function when you do not want the notification sound to sound, such as night time.

1

Operation stopped



Press both for 3 seconds

- A beep will sound and setting is complete.

- When both the VERTICAL SWING button and STOP button are pressed and held for 3 seconds again, "beep beep" will sound and notification sound will be set to sound again.

NOTE

- This setting will be canceled once the power plug is unplugged and notification sound will sound.

HOW TO DRAIN

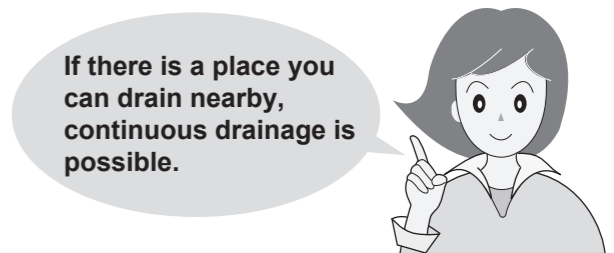

WATER TANK

When the water tank becomes full (approx. 4.2L), the operation will automatically stop (Full tank stop device)

- Laundry Deodorizing may be operated with a full tank. The Tank FULL indicator light (red) will not blink during this time.
- When the water tank is placed back after draining, the Tank FULL indicator light (red) will go off and operation will start again.

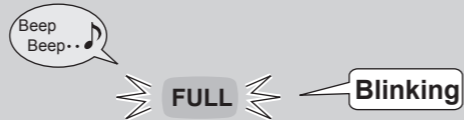

1 **Take out the water tank**

- Pull out straight while holding down the main unit.
- Gently pull out and carefully carry without tilting or dropping so no water will spill.

2 **Dispose water**

3 **Set the water tank to the main unit**

- Push in completely.
- Gently push in. (Rough handling may cause malfunction.)

NOTE

- Always stop the operation and dispose water before moving the main unit. (Water in the tank may spill and damage household goods.)
- Clean the inside of water tank periodically (about once a week). (Failing to clean for a long period of time may increase mold and bacteria which causes bad odor.)

CONTINUOUS DRAINAGE

Important Notices When Using Continuous Draining Operation.

- This dehumidifier is made for household use. When conducting Continuous Drainage, check for dirty filters (once every two weeks) and clogging of drain hoses periodically.
- Place the drain hose where the temperature will not fall below zero. (When the water in the hose freezes, the water inside the main unit may leak into the room and soak household goods)
- Put a net over the hose tip to prevent from insects coming in.
- Auto Off function will operate after 12 hours for Continuous Drainage as well. To release the Auto Off function, please read "To cancel the Auto Off function" on (Page 11).

How to pipe the hose

Always have the tip slanted. Do not bend. Do not put the hose tip into the water.

To stop continuous drainage and restore the original position

Take the hose off from drain outlet and put the rubber cap on.

1 **Unplug the power plug**

2 **Take out the water tank and take off the rubber cap on the back side**

3 **While pressing the drain stopper with your right finger, run the hose through the continuous drainage hole on the back of the main unit and securely insert into drain outlet**

- * Do not use an old hose with wide opening. (Otherwise, water may leak.)
- * Make sure the hose is inserted all the way in.

Press with your right finger

Insert with your left hand
Commercial hose inner diameter 15mm (outer diameter up to 21mm)

4 **Set the water tank to the main unit**

HOW TO DRAIN

CARE AND MAINTENANCE

We recommend periodical cleaning for a long, clean and sanitary use!



IMPORTANT NOTICES DURING CLEANING

Please use the specified cleaners

Do not use the following. (Otherwise, the surface may be damaged or cracked.)



Thinner
Benzine
Alcohol



Oven cleaner
Cleanser
Bleach



Housing and furniture
Synthetic detergent
(Alkaline)



Spray cleanser
Steel wool

FILTER/SENSOR

Once every two weeks

1

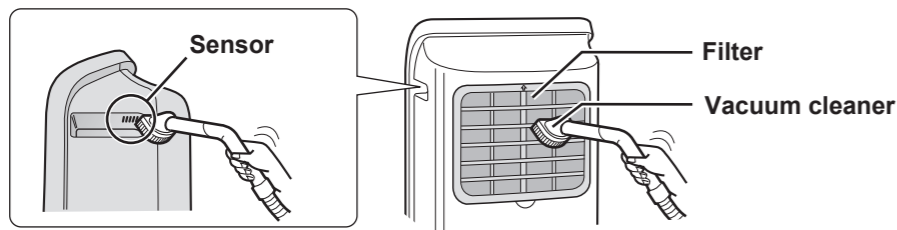

Remove the dust with vacuum cleaner

For heavy dust

Take off the filter cover → Take the filter off from the cover → Wash off the dust from the net and dry it (Remove gently with a small brush)

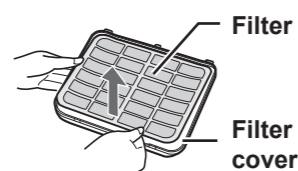
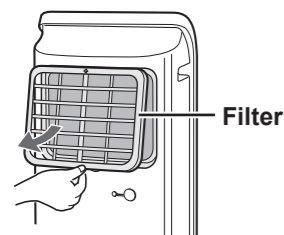

Use mild detergent (dishwashing soap) in lukewarm water for heavier dusts.



Attach the filter to the cover

(Securely place the 4 filter tabs)

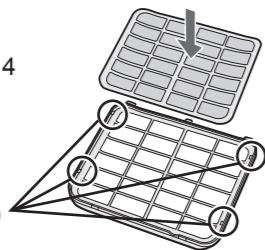

Tab (4 places)

Reattach to the original place

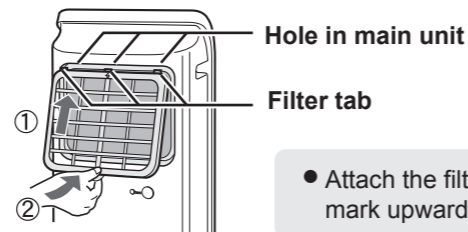

• Attach the filter with ↑ mark upwards.

NOTE

- Clogged filter may cause reduced dehumidification or consume more electricity.
- Dust will accumulate inside the main unit without the filter which may cause malfunctions.

WARNING

Always turn the operation "OFF" and unplug the power plug.

[Otherwise, electric shock or injury may be caused]

WATER TANK

Once a week

1

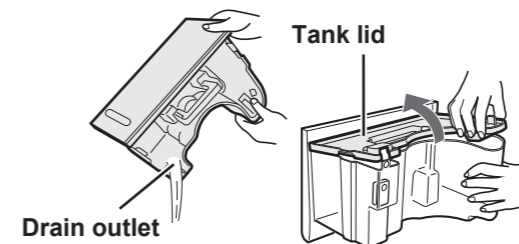

Dispose water and take the tank lid off

• Remove the lid slowly from the corner.

2

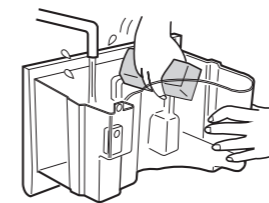

Wash the inside of the tank

• Wash the tank with dishwashing sponge.
• Use mild detergent (dishwashing soap) with lukewarm water if necessary.

3

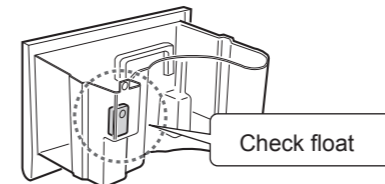

Dry the tank with soft cloth

• Check to see if the float is securely attached.

If float comes off

① Check the direction of float, and then insert the float.
(Magnet: Facing up Facing outside of tank)

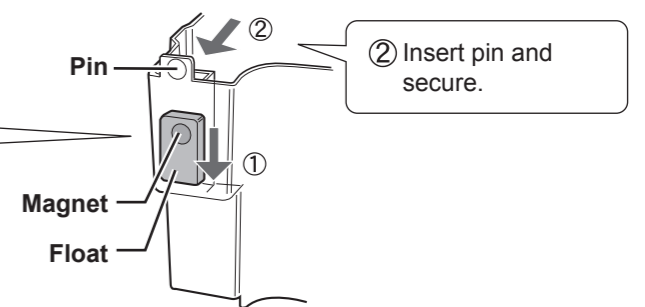
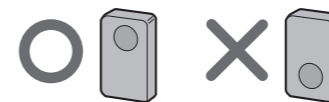

② Insert pin and secure.

4



Put the tank lid on

• Be sure to tightly close the tank lid. (To prevent water leakage)

NOTE

- Be careful not to damage the float.

CARE AND MAINTENANCE (Continued)

We recommend periodical cleaning for a long, clean and sanitary use!



SPECIFICATIONS

MAIN UNIT Once a month

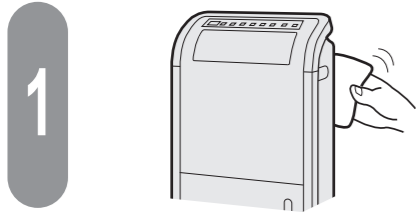

Soak a soft cloth in lukewarm water (40°C or lower) or mild detergent to wipe dirt off

- Wipe off any excessive detergent with a damp cloth thoroughly.
- Do not forget to clean air inlet, air outlet, and casters as well.

NOTE

- Poor insulation or rust may occur if the main unit gets wet.
- When using chemical agent, please follow the direction for use.

WHEN NOT USING FOR A LONG PERIOD OF TIME

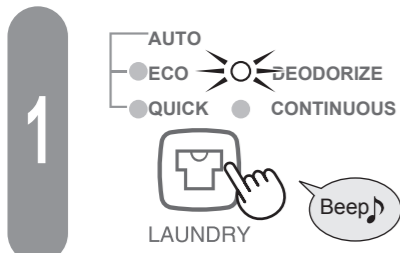

Conduct internal drying operation (Laundry deodorizing mode)

Internal drying

- Sometimes there are moistures on the cooler inside the main unit. Run the laundry deodorizing operation (air flow mode) for about 2 hours. (Using the OFF TIMER is useful) This will dry the inside of main unit and prevents mold from forming.

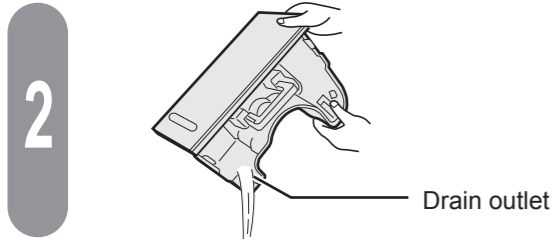

Dispose water
(Page 19)

- Take the tank lid off and wipe off any water on the tank.

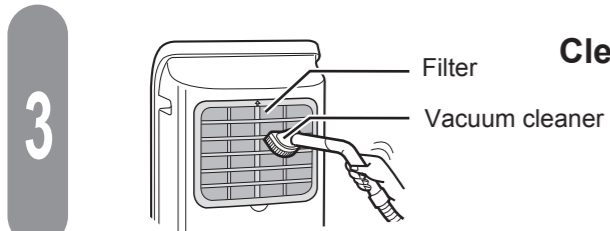

Clean the filter
(Page 18)

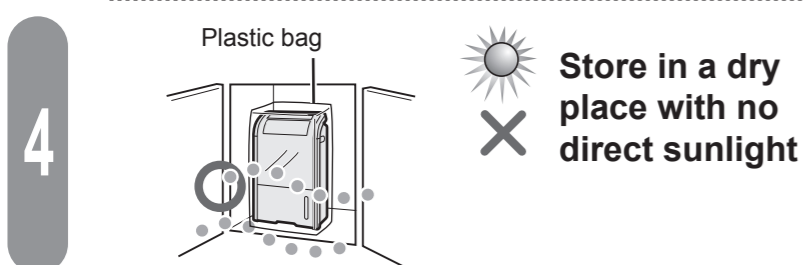

Store in a dry place with no direct sunlight

- Put in the original box or place a cover (plastic bag) over the unit to prevent dust and store.
- If dust get in, the main unit may shoot out dust the next time it is operated.

| | | |
|------------------------|----------------------------|-----------|
| Model | DW-D20A | |
| Power Supply | 220V-240V/50Hz | |
| Dehumidifying Capacity | 30°C/80%RH | 20L/day |
| | 26.7°C/60%RH | 12.5L/day |
| Power Consumption | 26.7°C/60%RH | 270W |
| Standby Status | 0.45W | |
| Dehumidification Area | 25-50m ² | |
| Water Tank Capacity | Approx. 4.2L | |
| Length of Power Cord | Approx. 1.8m | |
| Dimensions | 374mm(W)×250mm(D)×620mm(H) | |
| Weight | About 15kg | |

- Dehumidifying Capacity: the amount of humidity that a dehumidifier removes from the air in a day when room temperature and relative humidity are kept at 30°C/80%RH and 26.7°C/60%RH respectively.
- Power Consumption: the consumption value when fan speed reaches the highest.
- Dehumidifying Area: according to standards of JEMA.
※ Standby Status: the power plug is plugged in the socket while the Power ON/Off button is set at "Off".

TROUBLESHOOTING

Please check one more time before calling for services.



| Problem | Solution | Reference Page |
|--|--|--|
| The room becomes hot | <ul style="list-style-type: none"> Warm air will come out from the air outlet during (ECO/QUICK/CONTINUOUS) laundry drying operation and dehumidifying operation, and if used in an enclosed room, the room temperature will go up. | — |
| The unit does not dehumidify | <ul style="list-style-type: none"> The dehumidification level varies with the size, structure, temperature and humidity level of the room. When room temperature or humidity level is low, the dehumidification level will be low in general. | — |
| Dehumidification amount is low (Water does not accumulate in the tank) | <ul style="list-style-type: none"> Low humidity of less than 50% cannot be maintained. Air flow mode will operate during auto dehumidifying operation when room temperature or humidity level is low, and the unit will not dehumidify. When the room temperature is below 3°C, air flow mode will operate to prevent the water tank's water from freezing, and the unit will not dehumidify. When the room temperature is higher than 38°C, the protective device will activate, the air flow mode will operate, and the unit will not dehumidify. When the room temperature is 15°C or under, the unit automatically defrosts by switching to air flow mode which makes water harder to collect. Check to see if the unit runs in laundry deodorizing operation. <ul style="list-style-type: none"> ⇒ Switch to (ECO/QUICK/CONTINUOUS) laundry drying and dehumidifying operation. Check to see if the filter is clean. <ul style="list-style-type: none"> ⇒ If dirty, clean the filter. Check to see if the air outlet or air inlet is blocked. <ul style="list-style-type: none"> ⇒ Remove whatever blocks the port. | — — 10 10 11 — 18 — |
| The water leaks | <ul style="list-style-type: none"> Make sure you do not tilt, knock over or drop the main unit. <ul style="list-style-type: none"> ⇒ Use the unit at a level, stable place with free of vibration. Check to see if the hose is disconnected from the drain outlet of the main unit during continuous drainage. <ul style="list-style-type: none"> ⇒ Install the hose by pushing it all the way in. | — 17 |
| The humidity level does not go down | <ul style="list-style-type: none"> The room may be too big. The opening/closing of windows and doors may be too frequent. Check to see if anything that release steam is in use such as an oil heater. | — — — |
| Laundry does not dry | <ul style="list-style-type: none"> Check to see if AUTO mode (QUICK/ECO laundry drying) is operating. <ul style="list-style-type: none"> ⇒ The AUTO operation will stop automatically after a maximum of 3 hours. Laundry may not be dried enough depending on the room situation. Operate AUTO mode again or switch to the CONTINUOUS laundry drying operation. | 12 |

| Problem | Solution | Reference Page |
|--|---|----------------|
| There is a sound at the start of operation/during operation/when the unit stops | <ul style="list-style-type: none"> Buzzing sound... This is the operating sound of the compressor. Whipping, howling sound... This is the sound of refrigerant (coolant) circulation. | 3 3 |
| The sound is too loud | <ul style="list-style-type: none"> The unit will sound loudly for the first few seconds upon power-on when the room temperature is low. (This duration will vary with the temperature.) Check to see if the dehumidifier is properly placed on the floor or if the floor is unstable. <ul style="list-style-type: none"> ⇒ Use the unit at a level, stable place with free of vibration. Check to see if the filter is clogged. <ul style="list-style-type: none"> ⇒ Clean the filter. | 3 10 18 |
| The unit cannot operate Buttons do not work | <ul style="list-style-type: none"> Check the CHILD LOCK setting. <ul style="list-style-type: none"> ⇒ If locked, release the child lock. | 14 |
| The operation stops | <ul style="list-style-type: none"> Check the power plug. <ul style="list-style-type: none"> ⇒ If not inserted, insert the power plug into an outlet. Check to see if there is a power outage. <ul style="list-style-type: none"> ⇒ If there is a power outage, wait until the power is resumed. | — — |
| The tank FULL indicator light is blinking | <ul style="list-style-type: none"> Check to see if the water tank is properly placed. <ul style="list-style-type: none"> ⇒ If not, place the water tank correctly. Check to see if the water tank is full. <ul style="list-style-type: none"> ⇒ If the tank is full, drain the water. Check to see if the float is properly placed. <ul style="list-style-type: none"> ⇒ If not, place the float properly. | 16 16 19 |
| The OFF TIMER "6h" indicator light is blinking | <ul style="list-style-type: none"> The operation has stopped with the Auto Off function. <ul style="list-style-type: none"> ⇒ Press the STOP button to stop the indicator light from blinking, and start the operation again. When using continuously, disable the Auto Off function. | 11 |
| The tank FULL indicator light and the OFF TIMER "6h" indicator light are blinking | <ul style="list-style-type: none"> The water tank became full and the operation has stopped with the Auto Off function. <ul style="list-style-type: none"> ⇒ Empty the water tank, press the STOP button to stop the indicator light from blinking, and start the operation again. | 10,16 |
| The QUICK indicator light is blinking | <ul style="list-style-type: none"> QUICK (AUTO) laundry drying operation has completed and the operation has stopped. <ul style="list-style-type: none"> ⇒ Press the STOP button to stop the indicator light from blinking, and start the operation again. | 12 |
| The ECO indicator light is blinking | <ul style="list-style-type: none"> ECO (AUTO) laundry drying has completed and the operation has stopped. <ul style="list-style-type: none"> ⇒ Press the STOP button to stop the indicator light from blinking, and start the operation again. | 12 |
| Other indicator lights blinking | <ul style="list-style-type: none"> The unit may malfunction. <ul style="list-style-type: none"> ⇒ Please consult the store where you purchased the product or SHARP authorized service center. | — |

During operation

Sound

The unit does not operate

TROUBLESHOOTING

SHARP®

抽濕機

使用說明書

型號

DW-D20A

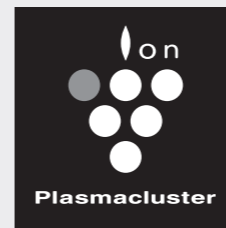

High-Density 7000 *

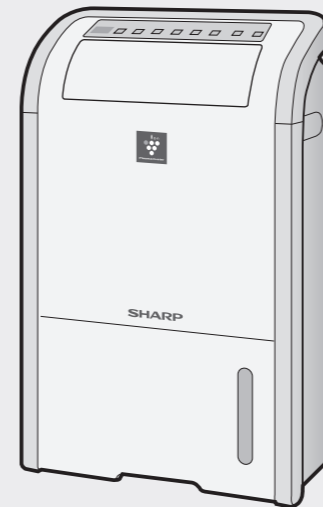

* 本技術所採用的數字是根據把抽濕機放在牆角，在衣物除臭模式下，將上下擺風設定為“DOWN”、左右擺風設定為“OFF”時，在房間(溫度 20°C，濕度 50%)的中央附近(距離地面 1.2 米)測出的每立方厘米空氣中Plasmacluster Ion的估計值。



此標誌及 Plasmacluster 都是SHARP 株式會社的註冊商標。

目錄

頁數

介紹

| | |
|--------|---|
| 特點 | 2 |
| 常見問題 | 3 |
| 安全注意事項 | 4 |
| 各部分名稱 | 6 |
| 使用前 | 8 |

如何使用

| | |
|--------------|----|
| 操作方法 | 10 |
| ●乾衣除濕、衣物除臭模式 | 10 |
| ●除濕模式 | 11 |
| ●停止 | 11 |
| 方便的功能 | 12 |
| ●搖擺送風 | 12 |
| ●兒童安全鎖 | 12 |
| ●定時關機 | 13 |
| ●PCI開/關 | 13 |
| ●關閉提示音 | 13 |
| 排水方法 | 14 |
| ●儲水箱 | 14 |
| ●連續排水 | 15 |

保養

| | |
|----------|----|
| 保養 | 16 |
| ●過濾網、感測器 | 16 |
| ●儲水箱 | 17 |
| ●主機 | 18 |
| ●長時間不使用時 | 18 |

必要時

| | |
|----------|----|
| 規格 | 19 |
| 故障時的檢查事項 | 20 |

感謝您購買SHARP抽濕機。
請仔細閱讀本使用說明書，以便正確地使用本產品。
在使用之前，請務必仔細閱讀“安全注意事項”。
請妥善保存此說明書以便日後翻閱。

特點



High-Density 7000 *

透過高濃度PCI及強力除濕功能，使室內晾曬的衣物迅速除臭及乾爽

快速乾衣

將風量調至最大，迅速乾衣後，將自動停止。

乾衣除濕模式

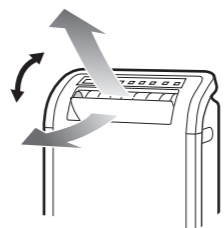
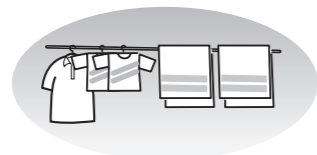

節能乾衣

綜合除濕和送風功能，有效使室內晾曬的衣物迅速乾爽，然後自動停止。

乾衣除濕模式

輕鬆除濕

保持一定的濕度，為房間營造一個舒適的環境。

自動除濕模式

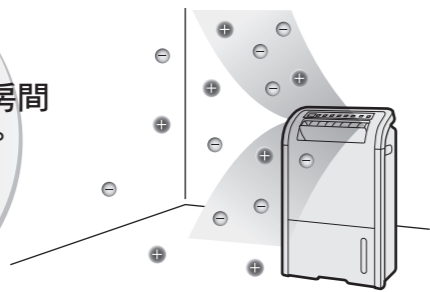

上下 160° 左右 90° 自動搖擺送風

通過廣闊的搖擺角度，進行大範圍除濕。

* 上下搖擺設定為“WIDE”、左右搖擺設置為“ON”時的送風範圍，會根據搖擺角度的不同而存在差異。

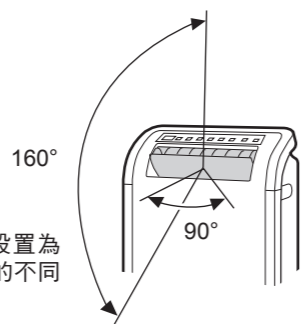

大型儲水箱

擁有 4.2L 儲水箱及連續排水功能，可充分滿足除濕需求。

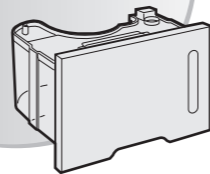

常見問題

Q 房間會不會變暖？

A 由於前面的出風口會吹出暖風，因此如在密閉的房間內操作時，會導致房間溫度上升。

Q 連續啟動除濕模式，可連續排水嗎？

A 可採用市面銷售的排水管(內徑 15mm)進行連續排水。(第 9、15 頁)

Q 儲水箱無水分積存，是否沒有進行除濕？

A 在高溫或溫度、濕度都比較低的時候，將自動轉為送風模式，而不進行除濕，因此儲水箱中無水分積存。(第 20 頁)

Q 聲音很大？

A 開始操作、停止操作時聽到聲音。
壓縮機操作的聲音以及製冷劑循環發出的聲音。(第 21 頁)

Q 目前濕度顯示不正確？

A 目前濕度顯示為大致濕度。(未必一定與其他設備顯示相同的數值)
此外，開始進行乾衣除濕時，濕度有機會產生巨大變化，可能與實際濕度產生差異。
濕度低於 31% 時顯示為“LO”，高於 91% 時則顯示為“HI”。

Q 風速無故變強？

A 即使設定了除濕(自動、弱)模式，在以下情況下，風速會自動增加。
●室溫在約 38°C 以上時…… 為使主機內部溫度下降(只送風)
●室溫在約 15°C 以下時…… 為預防主機內部結霜(只送風)

■ 此外，詳細情形請參考“故障時的檢查事項”。(第 20、21 頁)

* 本技術所採用的數字是根據把抽濕機放在牆角，在衣物除臭模式下，將上下擺風設定為“DOWN”、左右擺風設定為“OFF”時，在房間(溫度 20°C，濕度 50%)的中央附近(距離地面 1.2 米)測出的每立方厘米空氣中 Plasmacluster Ion 的估計值。

安全注意事項

為預防對用戶或他人導致危害及財產損失，特對應遵守的事項說明如下。

■ 若不遵守以下之安全事項或錯誤操作本機，則可能發生不同程度的危險：

警告

表示有可能會導致死亡或重傷。

注意

表示有可能會導致受傷或財物損失。

■ 請根據以下標記，遵守其表示的事項：

 表示不允許做的禁止事項。

 表示必須要做的強制事項。



警告

為預防火災、觸電、受傷

電源插頭及電源線

- 請勿使電源線破損
- 請勿對電源線進行任意更換、加工、強制彎曲、拉扯、扭曲、捆紮等
- 請勿對其承載重物或夾壓
- 移動時，請勿使腳輪輾壓電源插頭及電源線 (否則可能會導致電源線破損、火災、觸電)
- 請勿用潮濕的手插拔電源線 (否則可能會導致觸電)
- 電源線應避免中途連接、使用延長線，還應避免與其他電器用品共同使用一個插座 (否則可能會導致觸電、發熱、火災)
- 不可使用額定電壓(220V 50Hz)以外的電源
- 請勿以直接插入或拔出電源插頭來代替正常的主機開關 (否則可能會導致觸電或火災)

- 確認電源插頭上沒有積塵及沒有鬆動後，將其牢固地插入電源插座，及應定期用乾布擦拭電源插頭上的灰塵 (積塵或接觸不良可能會導致觸電或火災)
- 若要更換電源線，請聯絡聲寶維修服務中心

使用時

- 請勿將手指或異物(針狀物、金屬絲、棒狀物)插入吹出口或吸入口 (由於風扇在機內部高速運行，一旦接觸可能會導致受傷，接觸內部還可能會導致觸電、故障)
- 不可作任何改裝。禁止非維修技術人員進行分拆、改造或維修 (否則可能會導致火災、觸電、受傷)
- 請勿將噴霧器等罐子放在主機的附近。另外，請勿在主機附近使用易燃的危險物品(汽油、稀釋劑) (否則可能會導致火災、爆炸或火災)
- 請勿長時間被風直接吹著身體 (否則可能會導致身體不適、健康受損)
- 請勿把主機放在發熱器具的附近 (主機的樹脂部分熔化，可能會導致火災)

發生異常情況時(有燒焦異味等)

- 請立即停止操作，拔出電源插頭，並與聲寶維修服務中心聯絡 (否則可能會導致觸電或火災等)
- 需要維修時，請與聲寶維修服務中心聯繫 (如維修不妥善，可能會導致觸電、火災、受傷)

保養時

- 須停止操作，拔出電源插頭 (由於內部風扇正在高速運行，可能會導致受傷)



注意

為預防漏電、受傷或財物損失

電源插頭及電源線

- 須緊握電源插頭拔出 (否則可能會導致火災、觸電、短路)

- 長時間不使用時，為安全起見，須將電源插頭從插座中拔出 (否則可能會導致觸電、漏電、火災)

使用時

- 請勿使主機翻倒或從高處墮下
- 請勿在主機翻倒時收藏或移動本機 (否則可能會導致容器破損、漏水、漏電等故障)
- 請勿在牆壁或家具間的狹窄空間使用本機
- 請勿在出風口或過濾網上覆蓋布等物品 (通風不暢可能會導致發熱、起火)
- 請勿在易於被水濺濕的地方或浴室等使用本機
- 請勿用水直接清洗本機
- 請勿在主機上放置花瓶等含水的容器
- 僅限室內使用。請勿放置在被陽光直射或有風雨的地方使用
- 請勿放置在可能洩漏燃油或易燃氣體的地方 (否則可能會導致觸電、過熱、漏電、火災)
- 請勿放置在桌上等高處使用 (主機墮下時，可能會導致受傷)

- 請勿在產品上擺放或倚靠物品 (主機移動或翻倒時，可能會導致受傷)
- 請勿飲用除濕水或將除濕水用於動物飼養等 (否則可能會影響健康)
- 請勿將燃燒器具放置在出風口或風能到達的地方 (否則可能會導致燃燒器具不完全燃燒)
- 請勿用於保存美術品、學術資料或其他特別用途 (否則可能會降低保存品品質)
- 請勿在有人的房間長時間使用本機 啟動“衣物(快速、節能、連續)”模式或除濕模式時，產生的熱量會使房間溫度上升，使房間變得乾燥，可能會影響健康
- 下列人士使用本機時，請加以注意 (嬰幼兒、兒童、老人、無法自己操作本機的人士)

- 請在主機周圍預留一定的空間 (通風不暢可能會導致過熱、起火、故障、保護裝置啟動)

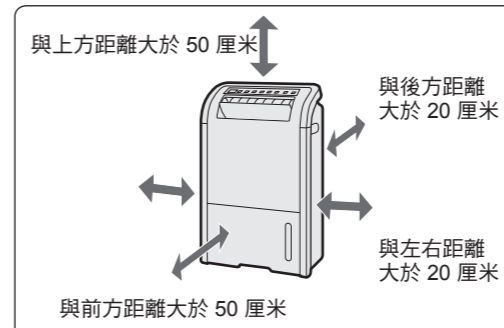

- 除非得到監護人或負責其安全人士的適當監督或指導，否則，此機器不適合身體官能或心智能力退化者，或缺乏操作經驗和知識的人士(包括兒童)使用

- 兒童應受到適當監管以確保不會以此機器作玩具
- 請勿在榻榻米、易損傷的地板、高低不平的地方、長毛地毯等處拖動腳輪來改變主機的方向 (否則可能會導致地板及地毯表面受損)
- 移動時，須停止操作，並把儲水箱中的水倒掉
- 在平坦及穩定的地方使用
- 連續排水時，避免水管彎折，使水管順利排水
- 使用排水管時，須確保周圍的溫度不低於零度 (儲水箱的水流向室內並弄濕家具等，可能會導致觸電、漏電、火災)
- 長時間在同一地方使用時，須注意本機下方及地板周圍等出現的污垢

注意

- 如對電視機、收音機產生干擾或電波手錶無法正確顯示時間時，請儘量遠離。 (否則可能會導致電磁波干擾)

請務必遵守

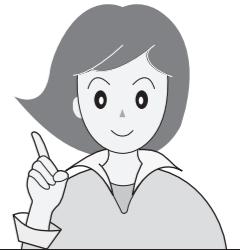

各部分名稱

按下帶有 ★ 標記的按鍵則開始運行。

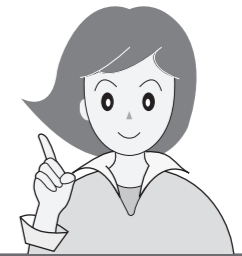

主機和操作面板

操作面板

PCI開/關鍵

PCI釋放模式設定為“ON”(開)或“OFF”(關)。
(第 13 頁)

PCI指示燈(藍)
點亮……PCI釋放中

目前濕度顯示(綠)

顯示目前濕度。

Lo ……31% 或以下
32-90 ……以 1% 為單位顯示目前濕度
Hi ……91% 或以上

兒童安全鎖鍵 (第 12 頁)

“開啟”或“解除”兒童安全鎖功能。
兒童安全鎖指示燈(綠)
點亮……兒童安全鎖處於開啟狀態

定時關機鍵 (第 13 頁)

設定自動關閉主機的時。定時關機指示燈(綠)

“2h” 點亮……關機定時器設定為 2 小時
“4h” 點亮……關機定時器設定為 4 小時
“6h” 點亮……關機定時器設定為 6 小時
“6h” 閃爍……因自動關機功能而停止操作(第 9 頁)

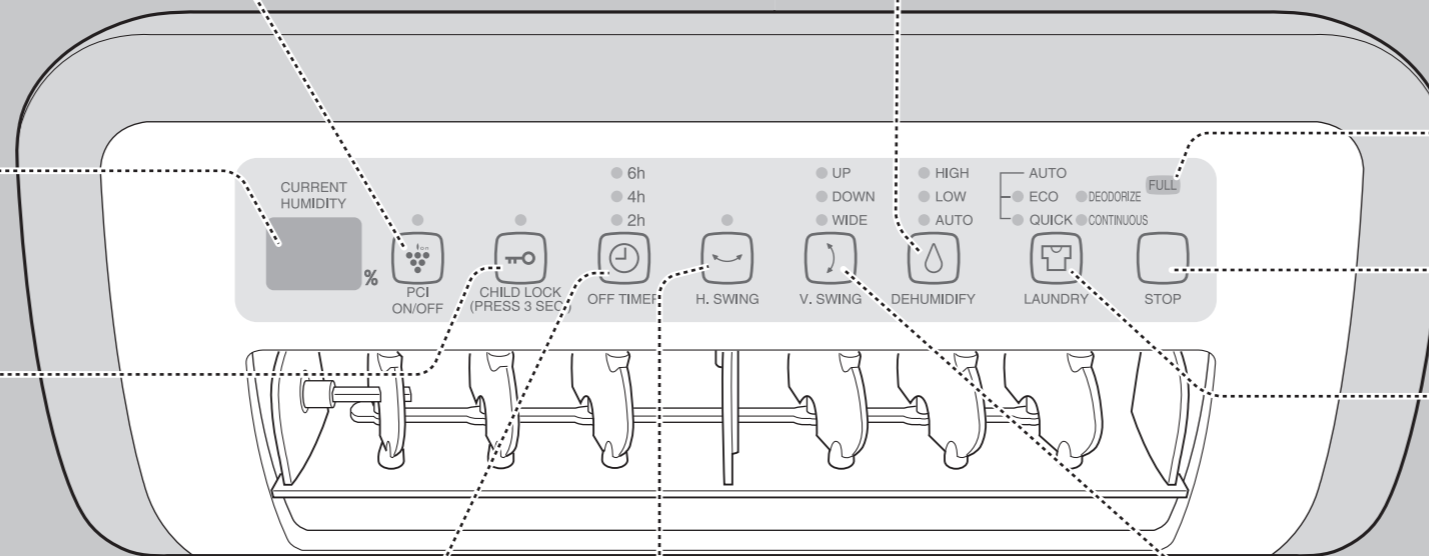

除濕鍵★ (第 11 頁)

切換到除濕模式。
除濕切換指示燈(綠)
顯示運行狀態。

→○← HIGH (高)
↑
→○← LOW (低)
↑
→○← AUTO (自動)

水滿指示燈(紅) (第 14 頁)

閃爍……儲水箱已滿

停止鍵 (第 11 頁)

停止操作。

乾衣除濕鍵★ (第 10 頁)

切換到乾衣除濕模式。
乾衣除濕切換指示燈(綠)
顯示運行狀態。

→○← DEODORIZE (除臭)
↑
→○← CONTINUOUS (連續)
↑
→○← ECO (節能)
↑
→○← QUICK (快速)

上下搖擺鍵 (第 12 頁)

切換到不同的上下搖擺模式。

Light off Off (關)
↑
→○← UP (上)
↑
→○← DOWN (下)
↑
→○← WIDE (廣闊)

左右搖擺鍵 (第 12 頁)

左右搖擺功能設定為“開”或“關”。

左右搖擺指示燈(綠)
點亮……自動左右搖擺

正面

導風板(吹出口) (第 12 頁)

儲水箱 (第 14、17 頁)

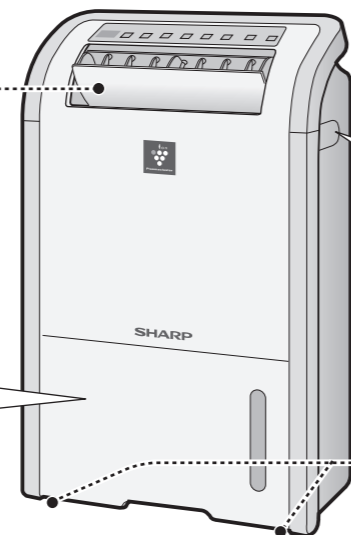
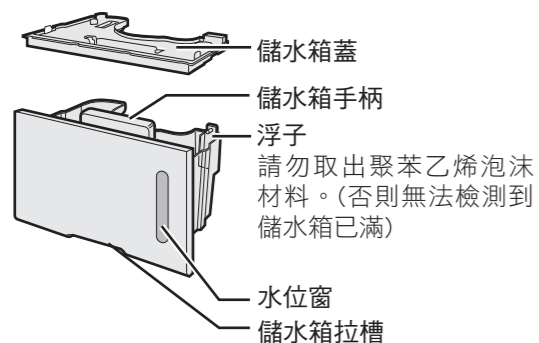

感測器(溫/濕度感測器)

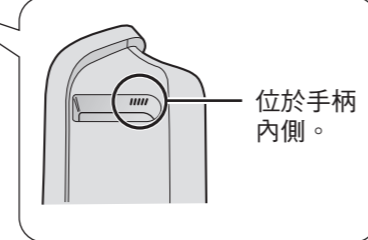

腳輪(4 個)

背面

過濾網(吸入口)

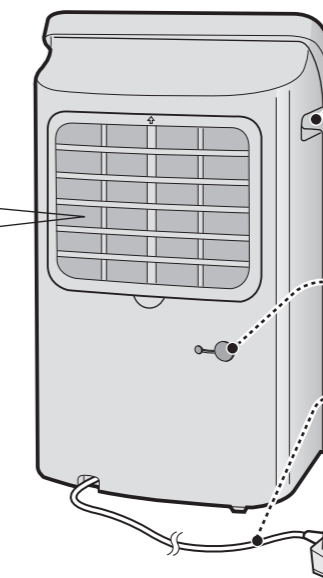
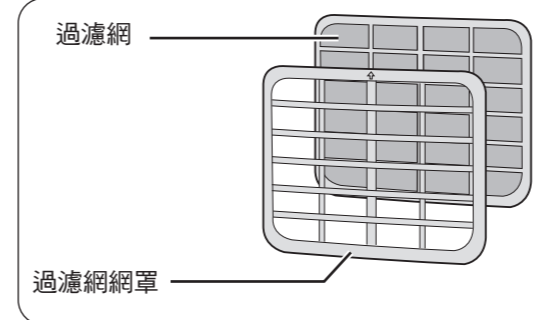

手柄(左右兩側) (第 9 頁)

連續排水孔(塞頭)

電源線

電源插頭

使用前

初次使用時

儲水箱中可能殘留水分，這是在工廠進行產品檢查時所留下的，並非異常。

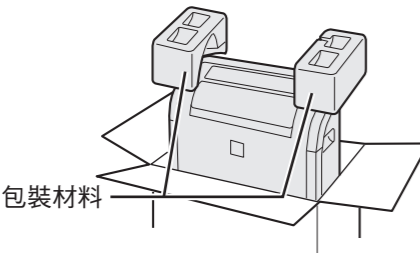
- 

從包裝箱中取出主機

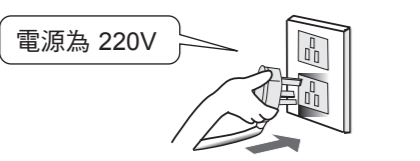
 - 請務必緊握手柄，從包裝箱中取出。
 - 包裝箱與包裝材料可用於存放產品，請妥善保存。
- 

放置在平坦穩固的地方，將電源插頭插入插座

 - 導風板將自動閉上。

安裝位置要求

避免陽光直射

- 否則，可能導致機殼脫色、變形或錯誤啟動安全裝置。

當對電視機、收音機等接收造成干擾、或電波手錶無法正常顯示時間時，請盡可能遠離這些電器。

放置在穩定及平坦的地方

- 若放置在長毛地毯或坐墊上，可能會導致翻倒。

請在約3°C~38°C的房間內使用

- 室溫低於3°C或高於38°C時，壓縮機的運行將停止，不再運行除濕模式。(進入低溫/高溫保護狀態，從而轉為送風模式)

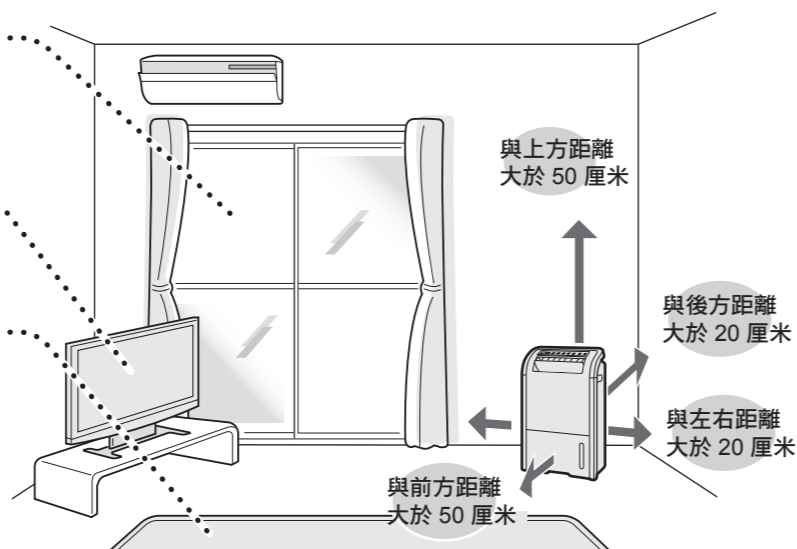

請勿在下列地方使用

- 海邊、鹽份較多的地方
- 溫泉等硫化氣體較多的地方
- 機械油較多的地方
- 水蒸氣或油煙較多的地方

請勿在除濕機附近使用氟化乙烯樹脂或含矽酮配方的化妝品等*

- 如主機內部附著氟化乙烯樹脂或矽酮，可能導致無法釋放PCI。

* 護髮產品(護髮素、頭髮定型噴霧、頭髮護理液等)、化妝品、止汗產品、防靜電產品、防水噴霧、上光劑、玻璃清潔劑、化學抹布、蠟製品等。

注意



在榻榻米、易損傷的地板、高低不平的地方及長毛地毯等移動時，須將主機抬起

【否則可能會導致地板及地毯表面受損】

請予以瞭解的事項

移動時

1



停止操作，並排出儲水箱中的水

- 請收好電源線，緊握手柄移動。拖曳可能會導致電源線損壞。

2

手柄(左右兩側)

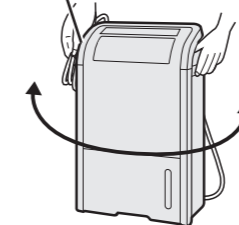

緊握手柄移動

腳輪

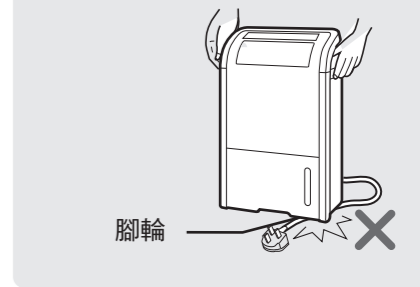

內部除霜

室溫低於約 15°C 時，由於主機內部可能會結霜，設備將自動進行除霜。

- 約 45 分鐘一次(運行約 12 分鐘左右)，在壓縮機停止運作、風量設定為“HIGH”(高)的狀態下運行。在房間溫度較低的時候，除霜的時間較長。
- 除霜時，因壓縮機停止運作，不進行除濕，所以儲水箱的積水量會減少。

自動關機功能

為預防忘記關機，主機運行 12 小時後將自動停止運行。(定時關機指示燈“6h”將會閃爍)



再次啟動時，請按“STOP”(停止)鍵解除指示燈閃爍，使抽濕機繼續運作。

解除自動關機功能(希望連續排水時)

插入電源插頭後，自動關機功能立即啟動。

運行停止時



同時按住 3 秒

- 同時按“OFF TIMER”(定時關機)鍵和“STOP”(停止)鍵 3 秒以上，在聽到“嗶”聲後，自動關機功能將會解除。

- 拔出電源插頭後，自動關機功能再次啟動。

- 若要重做此功能，重複以上步驟，聽到“嗶嗶”兩聲後，功能會重新啟動。

再次啟動時，除濕功能會在 3 分鐘後開始

- 在插入電源插頭或衣物(快速、節能、連續)模式及除濕模式停止後，為保護設備，壓縮機將停止操作約 3 分鐘。此時，主機只會進行送風模式，並不會進行除濕。

執行送風運行模式約 3 分鐘

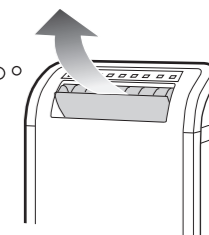

操作方法

注意

勿在出風口覆蓋衣物等物品

【否則可能會導致過熱、著火、故障】

乾衣除濕、衣物除臭模式



選擇喜歡的操作模式

- 插入電源插頭後，將立即啟動“QUICK”(快速)模式。
- 如不拔出電源插頭，將延續上一次運行模式。

1

自動運行

快速自動(自動停止) 希望快速乾衣時

在風量“最強”的狀態下乾衣。(乾衣除濕)

- 操作開始約 30 分鐘後，濕度低於 55% 或操作時間達到約 3 小時，將自動停止操作。(聽到“嗶…”的一聲後，操作停止，快速指示燈閃爍)

節能自動(自動停止) 希望減少電力消耗時

在風量“強”的狀態下，交替執行除濕模式(壓縮機運行)和送風模式(壓縮機停止)來乾衣除濕。

- 操作開始約 30 分鐘後，濕度低於 60% 或操作時間達到約 3 小時，將自動停止操作。(聽到“嗶…”的一聲後，操作停止，節能指示燈閃爍)

連續 希望連續乾衣時

將風量設置為“最強”連續乾衣。(乾衣除濕)

除臭 希望為衣物除臭時(送風模式運行)

在風量“最強”的狀態下，執行衣物除臭(送風)模式。

- 如PCI釋放設定為“OFF”，切換至此模式時，PCI將自動開啟。(無法將PCI釋放設定為“OFF”。)

2

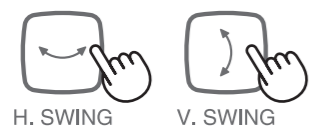

選擇搖擺送風模式(第 12 頁)

- 請將出風口吹出的風直接對準衣物。

出風口與衣物的距離須保持10厘米以上

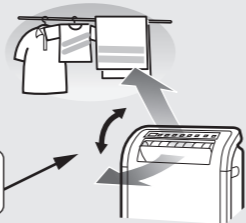

注意

- 請拉平脫水後衣物產生的皺褶，並放在通風處晾乾。
- 請將質地較厚的衣物放在通風情況良好的地方晾乾。
- 在室溫低、房間大、衣物較多時，乾衣時間會延長。在自動運行“QUICK”(快速)、“ECO”(節能)模式下，可能在衣物未乾時停止操作，此時並非故障，請再次啟動自動操作模式。

除濕模式



選擇喜歡的操作模式

- 插入電源插頭後，將立即操作“AUTO”(自動)模式。
- 如不拔出電源插頭，將延續上一次操作模式。

1

自動 希望自動除濕時

溫/濕度感測器將根據房間溫度調節除濕量，以達到合適濕度。

房間溫度過低或過高時，可能無法調節到合適濕度。(第 20 頁)

| 房間溫度 | 合適濕度 |
|---------|------|
| 3~26°C | 60% |
| 26~38°C | 55% |

弱

連續以“LOW”風量運行，進行靜音除濕。

* 有時風量會根據室溫增大。(第 3 頁)

強

連續以“HIGH”風量運行，進行除濕。

2

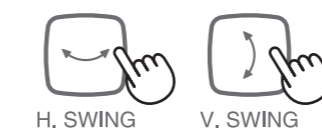

選擇搖擺送風模式(第 12 頁)

停止

1



- 指示燈熄滅，搖擺送風自動關閉。
- 長時間不使用時，請啟動內部除濕(衣物除臭)模式。(第 18 頁)

操作方法

方便的功能

搖擺送風

請勿用手強行撥動導風板。否則可能會導致故障。

左右

正在運行
搖擺“開”



H. SWING

搖擺“關”



H. SWING

- 請在希望停止的位置按鍵，指示燈將熄滅。

正在運行

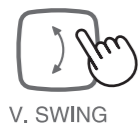

V. SWING

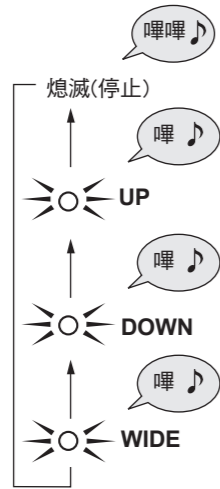

搖擺角度：約 160°
(送風範圍：約 180°)

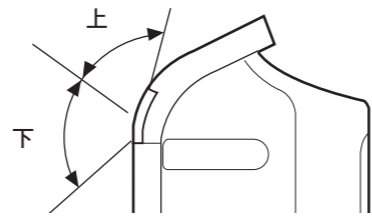

“WIDE” 交替執行 “UP”、 “DOWN”。

上下

兒童安全鎖

避免兒童觸碰或錯誤按下操作鍵。

開啟解除

“開啟”



CHILD LOCK
(PRESS 3 SEC.)

“解除”

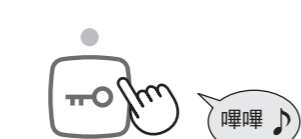

CHILD LOCK
(PRESS 3 SEC.)

- 開啟後，只能進行以下操作。
運行時...停止操作及解除兒童安全鎖。
停止時...解除兒童安全鎖。
- 拔出電源插頭後，兒童安全鎖將被解除。

定時關機

運行時



OFF TIMER

選擇希望關機的時間

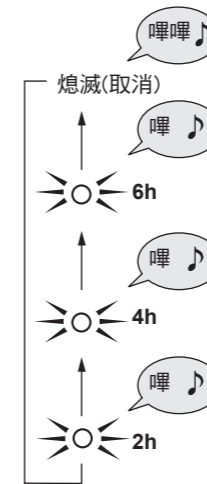

- 達到設定時間時，在發出“嗶...”的一聲通知音後，停止操作。

- 定時關機指示燈的顯示會隨運行時間發生變化。
- 在設定定時關機後，儲水箱如達到滿水狀態時，操作將停止，但定時關機時間的倒數繼續執行。(排水後可以繼續使用)
- 希望解除定時關機時，請按定時關機鍵，定時關機指示燈將會熄滅。

1

PCI開/關

每按一次，切換PCI開/關操作設定。

運行時

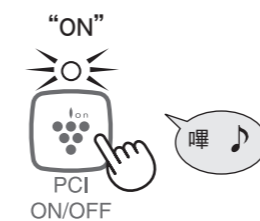

PCI
ON/OFF

“OFF”

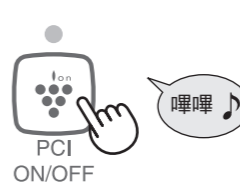

PCI
ON/OFF

- 即使將PCI設定為“OFF”，在衣物除臭模式下，將自動啟動PCI功能。

1

關閉提示音 (滿水時/到達定時關機時間/關機功能結束時)

在晚上休息，或想取消“提示音”時，請使用本功能。

運行停止時

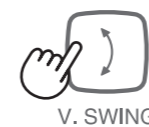

V. SWING



STOP

同時按住 3 秒

- 聽到“嗶”的一聲後完成設定。

- 再次同時按上下搖擺鍵和停止鍵 3 秒以上，在聽到“嗶嗶”兩聲後，啟動提示音功能。

注意

- 拔出電源插頭後，設定被解除，提示音響起。

方便的功能

排水方法

附近如有排水地方，
可進行連續排水。



儲水箱

儲水箱為滿水狀態時(約 4.2L)，
將自動停止運作(滿水停止裝置)，水滿指示燈將會閃爍。

- 運行衣物除臭功能時，在儲水箱滿水狀態下仍能操作。此時，“水滿指示燈”(紅)會熄滅。
- 排水後，將儲水箱重新裝入主機，“水滿指示燈”(紅)將會熄滅，主機將再次運行。

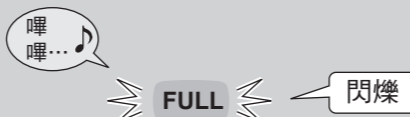

1

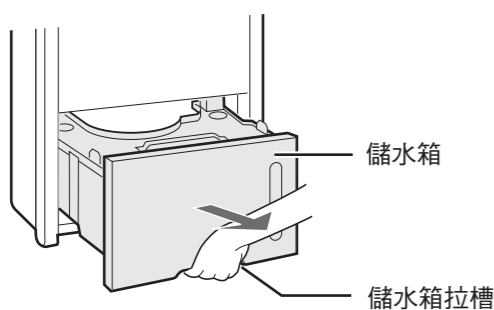

取出儲水箱

- 請穩住主機的同時，直接抽取。
- 請在抽取時保持平穩以防水溢出來，同時，為預防傾斜或掉落請小心移動。

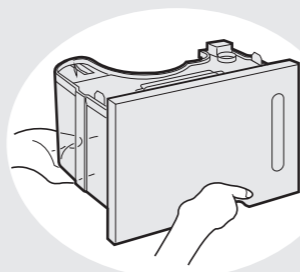

2

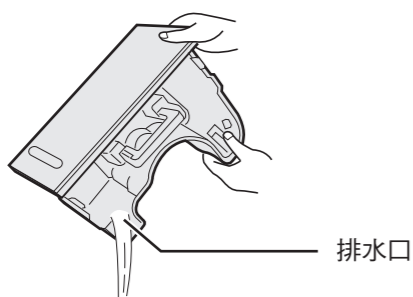

排水

3

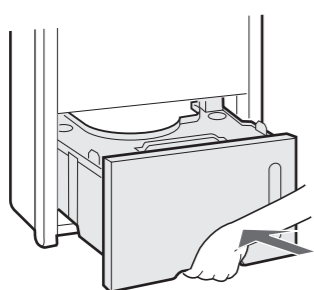

裝回儲水箱

- 牢牢插入。
- 勿粗暴安裝。(否則可能會導致故障)

注意

- 移動主機時，務必停止操作，進行排水。
(否則可能會導致儲水箱內的水因移動時的震動而溢出，濺濕家具或地板等)
- 請定期清掃儲水箱內壁。(約每週清掃一次)
(長期不清掃可能會產生黴菌、雜菌滋生，發出惡臭)

連續排水

運行連續排水模式時的注意事項

- 本抽濕機為家用型抽濕機。運行連續排水模式時，請定期(每兩週一次)檢測過濾網是否有污垢、排水軟管是否堵塞，確保無異常狀況。
- 請將排水管放置在水管四周不低於零度的地方。
(水管中的水發生凍結後，導致主機中的水流向室內並弄濕家具等)
- 水管的前端容易爬入蟲子，建議安裝網罩。
- 運行連續排水模式時，在運行 12 小時後，將啟動自動關機功能，令主機自動停止。關於自動關機功能的解除，請參考“自動關機功能的解除方法(第 9 頁)”。

水管的拔出方法

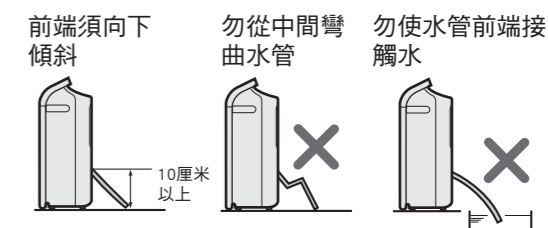

停止連續排水，還原成初始狀態時

請從排水口取下水管，並裝上塞頭。

1



拔出電源插頭

2

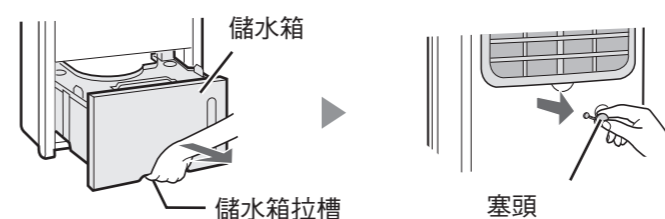

取出儲水箱，拔出背面的塞頭

3

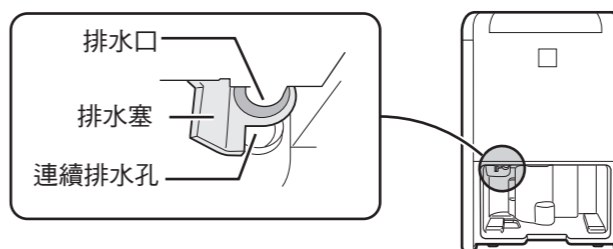

利用右手手指按住排水塞，並通過左手從主機背面的連續排水孔放入水管，再牢牢插入主機的排水口



* 請勿使用管口已經擴張的舊水管。
(否則可能會導致漏水)

* 請確認水管是否已插入深處。

4

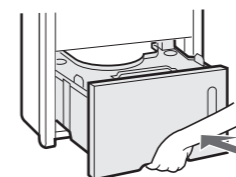

在主機上安裝儲水箱

保養



為了能夠清潔衛生地長期使用，請定期進行保養。

警告

保養時，請務必停止操作，並拔出電源插頭

【否則可能會導致觸電或受傷】

保養時的注意事項

請使用中性的清潔劑

請不要使用以下物品 (否則可能會導致表面損傷、破裂)

| | | | |
|--------------------------|------------------------------|----------------------------------|-------------------------|
| <p>稀釋劑 汽油 酒精</p> | <p>烤箱清掃劑 去污劑 漂白劑</p> | <p>住宅、家具用 合成清潔劑 (鹼性)</p> | <p>噴霧式清潔劑 金屬清掃刷</p> |
|--------------------------|------------------------------|----------------------------------|-------------------------|

過濾網、感測器 每兩週一次

1 利用吸塵器吸除灰塵

感測器 過濾網 吸塵器

污垢嚴重時

取下過濾網網罩 → 從過濾網網罩上取下過濾網 → 浸洗過濾網並晾乾 (使用牙刷等輕輕去除灰塵)

污垢嚴重時，請使用已稀釋的中性清潔劑(食物器皿專用清潔劑)配合溫水清洗

將過濾網安裝在過濾網網罩上 (請將過濾網牢牢卡入 4 個邊角) → 按原樣安裝

主機孔 過濾網的邊角

● 將過濾網 凸印記朝上進行安裝。

4 處邊角

注意

- 過濾網堵塞容易導致除濕能力下降及浪費電力。
- 如運行未安裝過濾網的設備，主機內部容易因積聚灰塵而發生故障。

儲水箱 每週一次

1 進行排水後，再取下儲水箱蓋

排水口 儲水箱蓋

- 從四周緩慢取下。

2 清洗儲水箱及儲水箱蓋的內壁

- 請使用食物器皿專用的海綿清洗。
- 污垢嚴重時，請使用稀釋了的中性清潔劑(食物器皿專用清潔劑)配合溫水清洗。

3 用柔軟的布擦拭儲水箱水分

確認浮子

如果浮子脫落

① 請確認浮子的方向後再次插入。
(磁鐵：方向朝上 對準儲水箱外壁)

② 插入扣針。

扣針 磁鐵 浮子

4 安裝儲水箱蓋

- 將儲水箱蓋牢牢插入外部溝槽中。(否則可能導致漏水)

注意

- 請注意勿損壞浮子。

保養

保養 (續)

為了能夠清潔衛生地使用，請定期進行保養。

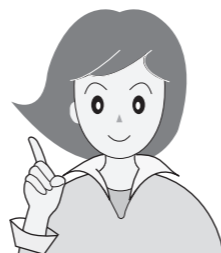

規格

| | | |
|-------|----------------------------|----------|
| 型號 | DW-D20A | |
| 電源 | 220V-240V/50Hz | |
| 抽濕能力 | 30°C/80%RH | 20公升/日 |
| | 26.7°C/60%RH | 12.5公升/日 |
| 耗電量 | 26.7°C/60%RH | 270瓦 |
| 備用狀態 | 0.45瓦 | |
| 抽濕面積 | 25 - 50平方米 | |
| 儲水箱容量 | 約4.2公升 | |
| 電源線長度 | 約1.8米 | |
| 外形尺寸 | 374毫米(闊)x250毫米(深)x620毫米(高) | |
| 重量 | 約15公斤 | |

* 抽濕面積以 JEMA(日本電機工業會)為標準。

* 抽濕能力是指連續保持室溫及相對濕度於 30°C/80%RH 及 26.7°C/60%RH 時的每天抽濕量。

* 耗電量是在最大風速下的數值。

* 備用狀態是指將電源插頭插入電源插座後而電源開關鍵設定在關的狀態。

主機

每月一次

1

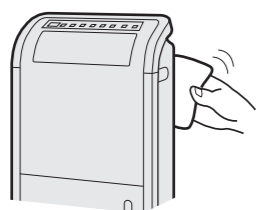

使用沾有溫水(40°C 以下)或中性清潔劑(食物器皿專用清潔劑)的濕布抹去污漬

- 須將濕布充分擰乾後再使用清潔劑。
- 吹出口、吸入口、腳輪同樣需要保養。

注意

- 如主機被水濺到，可導致絕緣變差或生銹。
- 使用含化學物質的抹布時，請按照注意事項執行。

長時間不使用時

1

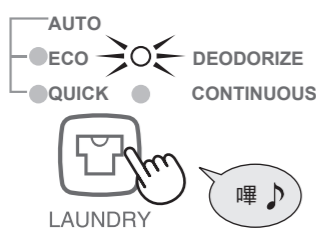

啟動內部除濕(衣物除臭)模式

內部除濕

- 主機內部的冷卻器可能會有水滴累積。請將衣物除臭(送風)模式開啟約 2 小時。(定時關功能令使用更加方便) 主機內部除濕後，可有效控制黴菌的產生。

2



排水 (第 17 頁)

- 打開儲水箱蓋，排去儲水箱的水，並把其擦試乾淨。

3

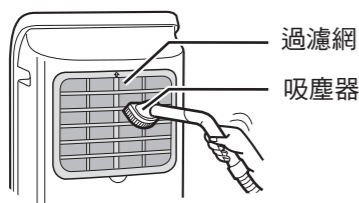

清掃過濾網 (第 16 頁)

4

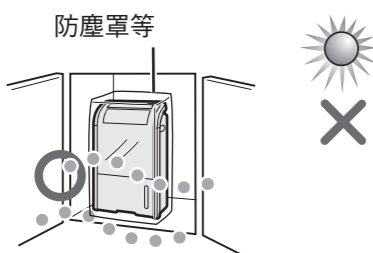

避免太陽直射，並在乾燥的地方進行存放

- 存放於購買時使用的包裝盒或覆蓋防塵罩(膠袋等)。
- 如存放時不使用防塵罩，灰塵會進入主機內部，在下次使用時，可能會吹出灰塵。

故障時的檢查事項

在委託維修或諮詢之前，請再檢查一次。



| 狀況 | 請進行檢查 | 參考頁數 |
|-------------------|--|---------------------------------------|
| 房間升溫 | <ul style="list-style-type: none"> 在啟動衣物(節能、快速、連續)、除濕模式時，由於吹出口有暖風送出，如關閉房間並長時間操作，會導致房間升溫。 | — |
| 不進行除濕 | <ul style="list-style-type: none"> 除濕量會根據房間的大小、結構、溫度、濕度的不同而存在差異。一般情況下，在室溫及濕度低時，除濕量會減少。 | — |
| 除濕量少 (儲水箱未積存水) | <ul style="list-style-type: none"> 濕度低於 50%，將不進行除濕。 啟動自動除濕模式時，在溫度和濕度都比較低的情況下，將運行送風功能，因此不進行除濕。 室溫低於 3°C 時，為了使儲水箱中的水不會凍結，將轉換為送風模式，因此不進行除濕。 在室溫高於 38°C 時，將啟動保護裝置，轉換為送風模式，因此不進行除濕。 室溫低於 15°C 時，由於自動進行除霜，將短暫運行送風模式。此時，可能出現積水較少的情形。 是否正在啟動衣物(除臭)模式？ ⇒請啟動衣物(節能、快速、連續)、除濕模式。 過濾網是否堵塞？ ⇒請清掃。 吹出口或吸入口是否堵塞？ ⇒請清除堵塞物 | — — 8 8 9 — 16 — |
| 漏水 | <ul style="list-style-type: none"> 主機是否傾斜擺放、或曾經翻倒或掉落？ ⇒請放置在無震動、平坦的地方使用。 連續排水時，排水管是否脫離主機的排水口？ ⇒請將排水管用內擠壓，直至安裝牢固。 | — 15 |
| 濕度沒有下降 | <ul style="list-style-type: none"> 房間是否過大？ 是否經常開關窗戶或門？ 是否使用了石油火爐等產生水蒸氣的設備？ | — — — |
| 洗滌衣物未乾 | <ul style="list-style-type: none"> 是否啟動了自動模式(快速乾衣模式、節能乾衣模式)？ ⇒自動運行時間最長為 3 小時，完成後將自動停止。 根據不同的房間情況，衣物有機會未完全乾透，請再次啟動自動運行模式或乾衣除濕連續模式。 | 10 |

運行時

| 狀況 | 請進行檢查 | 參考頁數 |
|---------------------------|--|----------------|
| 在開始運行、運行時或停止運行時聽到聲音 | <ul style="list-style-type: none"> “噠”...這是壓縮機運行的聲音。 “嘩啦啦”或“咕嚕咕嚕”...這是製冷劑循環發出的聲音。 | 3 3 |
| 聲音很大 | <ul style="list-style-type: none"> 如在室溫較低時操作本機，可能在開始的幾秒內聲音變大。(根據溫度條件的不同，時間也會發生相應的變化) 抽濕機是否發生晃動？ 地板是否不穩？ ⇒請放置在無震動、平穩且水平的地方使用。 過濾網是否發生堵塞？ ⇒請清掃。 | 3 8 16 |
| 無法運行 按鍵無反應 | <ul style="list-style-type: none"> 是否開啟了兒童安全鎖功能？ ⇒請解除兒童安全鎖功能。 | 12 |
| 運行停止 | <ul style="list-style-type: none"> 電源插頭是否鬆掉？ ⇒請將電源插頭插入插座。 是否發生停電？ ⇒請等待供電恢復。 | — — |
| 水滿指示燈閃爍 | <ul style="list-style-type: none"> 儲水箱是否正確放入？ ⇒請正確放入儲水箱。 儲水箱是否已達到滿水狀態？ ⇒請排水。 浮子是否安裝正確？ ⇒請正確安裝。 | 14 14 17 |
| 定時關機指示燈 “6h”閃爍 | <ul style="list-style-type: none"> 自動關機功能啟動。 ⇒請按停止鍵，消除指示燈閃爍，再次操作本機。 連續使用時，請解除自動關機功能。 | 9 |
| 水滿指示燈及定時關機指示燈 “6h”同時閃爍 | <ul style="list-style-type: none"> 儲水箱達到滿水狀態，自動關機功能啟動，運行停止。 ⇒請排出儲水箱中的水，按停止鍵，消除指示燈閃爍，再次操作本機。 | 9,14 |
| 快速指示燈閃爍 | <ul style="list-style-type: none"> 衣物快速(自動)運行結束。 ⇒請按停止鍵，消除指示燈閃爍，再次操作本機。 | 10 |
| 節能指示燈閃爍 | <ul style="list-style-type: none"> 衣物節能(自動)運行結束。 ⇒請按停止鍵，消除指示燈閃爍，再次操作本機。 | 10 |
| 其他指示燈閃爍 | <ul style="list-style-type: none"> 故障。 ⇒請向聲寶的維修服務中心諮詢。 | — |

設備不運行

故障時的檢查事項

